



# 16 Castledine Court

Balby, Doncaster, DN4 8SE

**Offers In The Region Of £155,000**

A great opportunity to purchase a two-bedroom mid-terraced townhouse located in the desirable area of Castledine Court, Balby, Doncaster. This property is an excellent opportunity for first-time buyers or investors, as it is brought to market with no onward chain, allowing for a smooth and straightforward purchase process.

The accommodation comprises: hall, lounge, kitchen/dining room to rear. First floor landing, master bedroom, second bedroom and bathroom. Outside there are gardens to front and rear. Driveway adjacent with parking for two vehicles. The property lies within easy reach of local shops, cafes, schools and easy access to local bus routes.

- Two bedrooms
- Mid terraced property
- Tandem parking
- Enclosed rear garden
- Lounge
- Kitchen/dining room
- Bathroom with shower over bath
- Ideal investment or FTB property
- Close proximity to schools, shops and host of amenities
- No onward chain

## Viewing

Please contact our Office on 01302 751616 if you wish to arrange a viewing appointment for this property or require further information.



Floor Plan

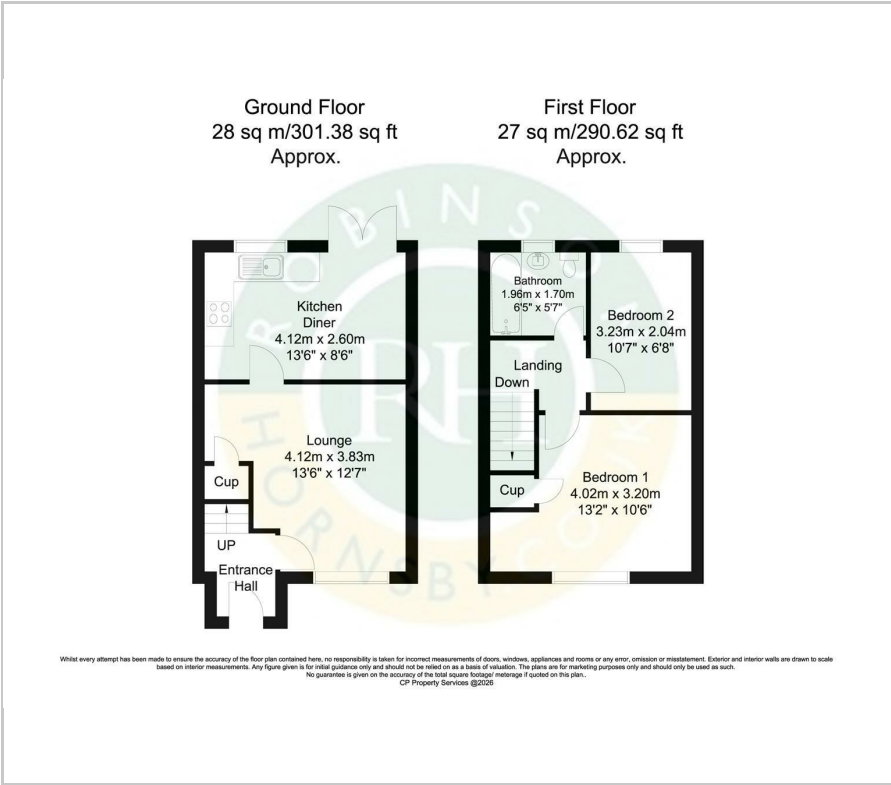

Area Map



Energy Efficiency Graph

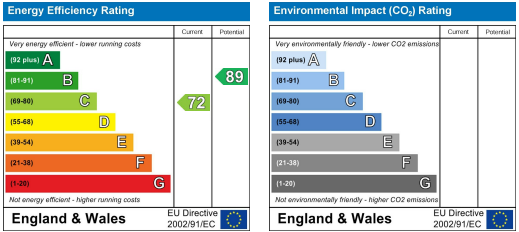

These particulars, whilst believed to be accurate are set out as a general outline only for guidance and do not constitute any part of an offer or contract. Intending purchasers should not rely on them as statements of representation of fact, but must satisfy themselves by inspection or otherwise as to their accuracy. No person in this firms employment has the authority to make or give any representation or warranty in respect of the property.